

Dec 20, 2013 - 12:03pm \\blue1\mess\FESS_ENG\Active Projects\6102222 - Conceptual Design\Drawings\S-01_S-02_6-10-22.dwg

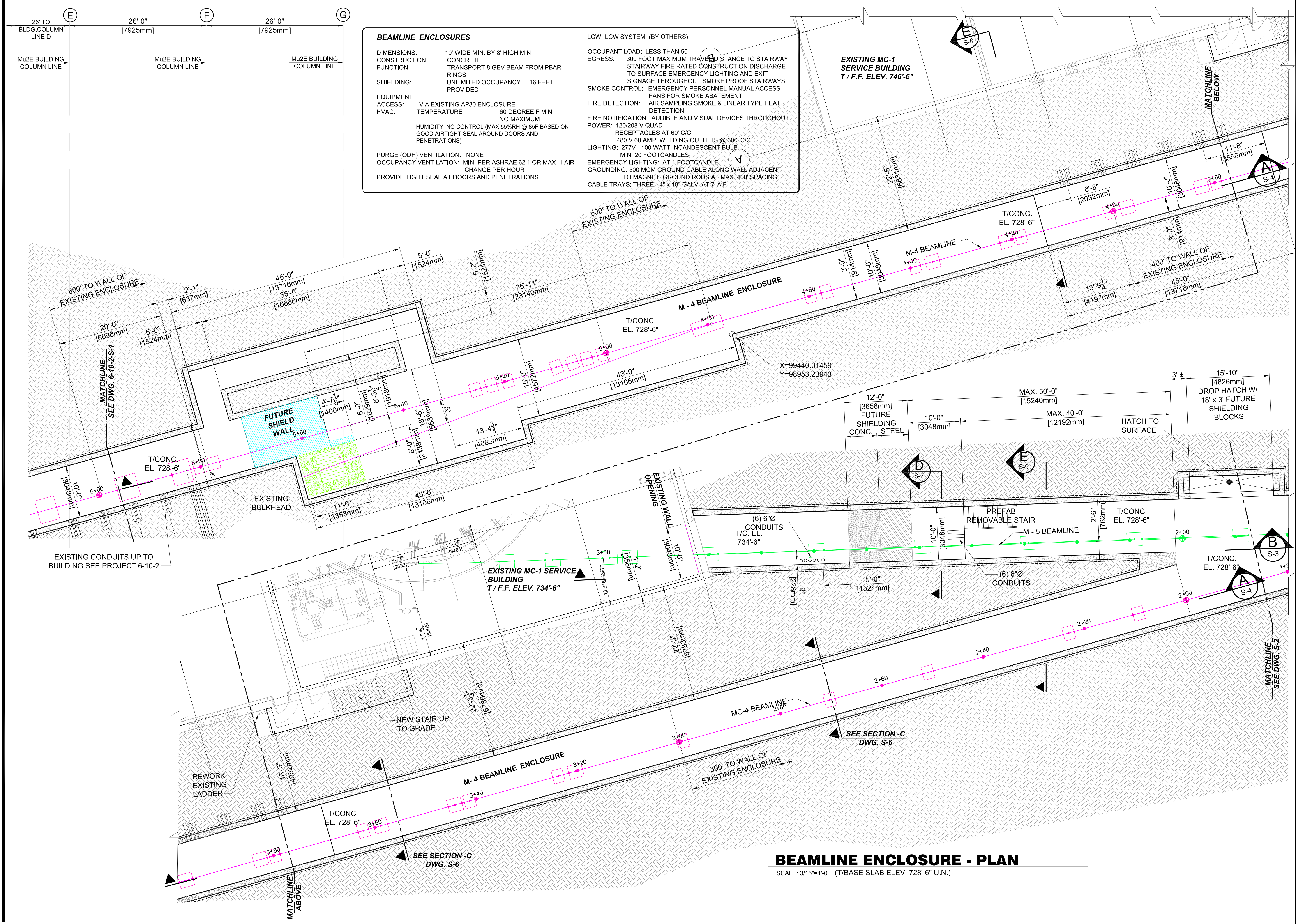

BEAMLINE ENCLOSURES		LCW: LCW SYSTEM (BY OTHERS)
DIMENSIONS:	10' WIDE MIN. BY 8' HIGH MIN.	OCCUPANT LOAD: LESS THAN 50
CONSTRUCTION:	CONCRETE	EGRESS: 300 FOOT MAXIMUM TRAVEL DISTANCE TO STAIRWAY.
FUNCTION:	TRANSPORT 8 GEV BEAM FROM PBAR RINGS:	STAIRWAY FIRE RATED CONSTRUCTION DISCHARGE TO SURFACE EMERGENCY LIGHTING AND EXIT SIGNAGE THROUGHOUT SMOKE PROOF STAIRWAYS.
SHIELDING:	UNLIMITED OCCUPANCY - 16 FEET PROVIDED	SMOKE CONTROL: EMERGENCY PERSONNEL MANUAL ACCESS FANS FOR SMOKE ABATEMENT
EQUIPMENT ACCESS:	VIA EXISTING AP30 ENCLOSURE	FIRE DETECTION: AIR SAMPLING SMOKE & LINEAR TYPE HEAT DETECTION
HVAC:	TEMPERATURE 60 DEGREE F MIN NO MAXIMUM HUMIDITY: NO CONTROL (MAX 55%RH @ 85F BASED ON GOOD AIRTIGHT SEAL AROUND DOORS AND PENETRATIONS)	FIRE NOTIFICATION: AUDIBLE AND VISUAL DEVICES THROUGHOUT
PURGE (ODH) VENTILATION:	NONE	POWER: 120/208 V QUAD RECEPTACLES AT 60° C/C 480 V 60 AMP. WELDING OUTLETS @ 300° C/C
OCCUPANCY VENTILATION:	MIN. PER ASHRAE 62.1 OR MAX. 1 AIR CHANGE PER HOUR	LIGHTING: 277V - 100 WATT INCANDESCENT BULB MIN. 20 FOOTCANDLES
PROVIDE TIGHT SEAL AT DOORS AND PENETRATIONS.		EMERGENCY LIGHTING: AT 1 FOOTCANDLE GROUNDING: 500 MCM GROUND CABLE ALONG WALL ADJACENT TO MAGNET. GROUND RODS AT MAX. 400' SPACING. CABLE TRAYS: THREE - 4" x 18" GALV. AT 7' A.F

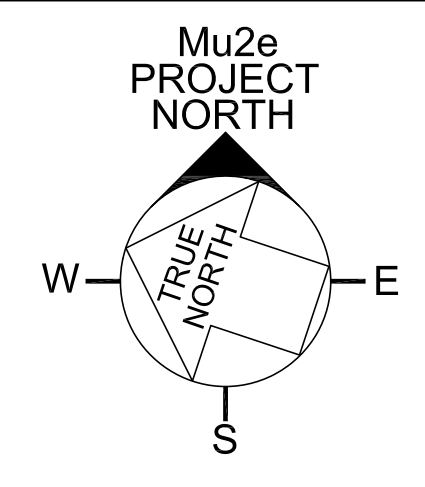
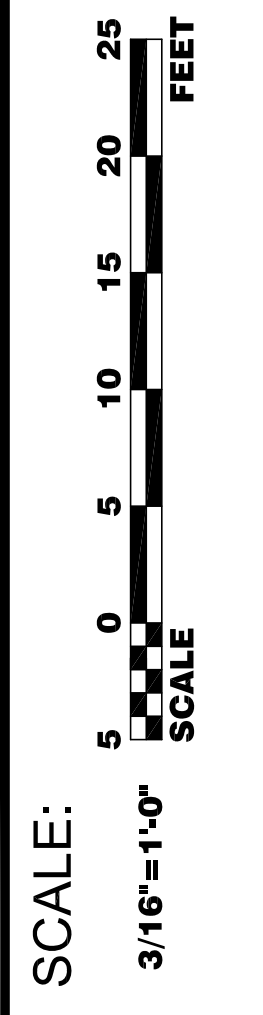

MC BEAMLINE ENCLOSURES
BEAMLINE ENCLOSURES PLAN - SHEET 1

CDR

 DATE
20 DEC., 2013
 PROJECT NO.
6-10-22
 DRAWING NO.
S-1

BEAMLINE ENCLOSURE - PLAN
SCALE: 3/16"=1'-0" (T/BASE SLAB ELEV. 728'-6" U.N.)

Dec 20, 2013 - 12:02pm \\blue1\mess\FESS_ENG\Active Projects\6102222 - Conceptual Design\Drawings\S-01_S-02_6-10-22.dwg

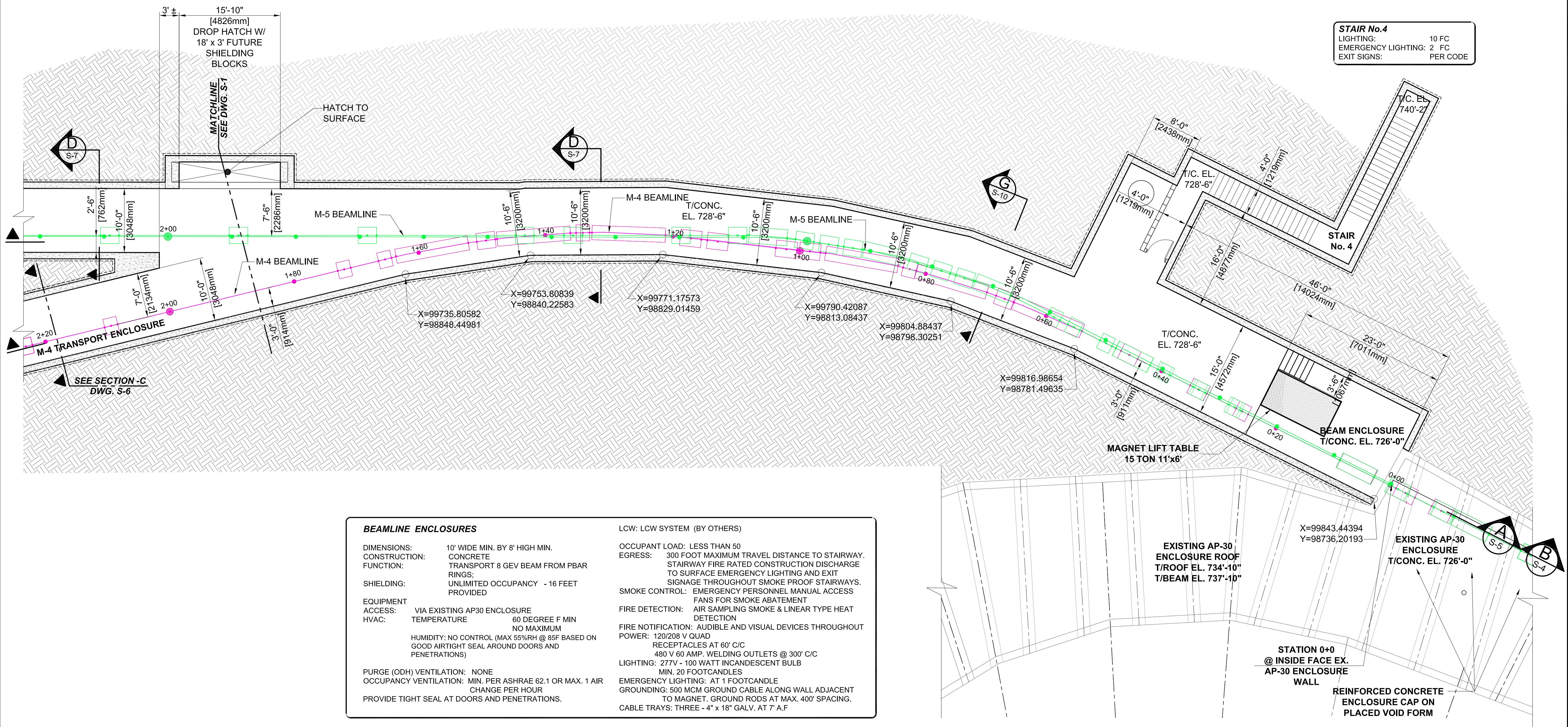

BEAMLINE ENCLOSURE - PLAN

SCALE: 3/16"=1'-0" (T/BASE SLAB ELEV. 728'-6")

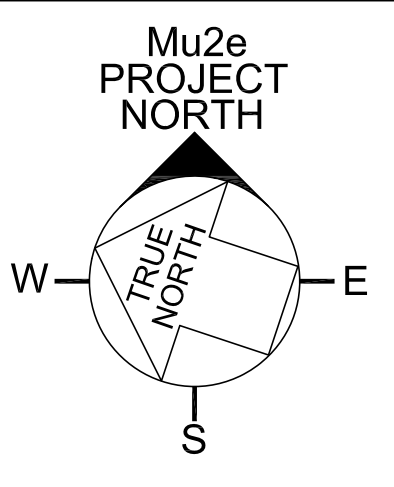
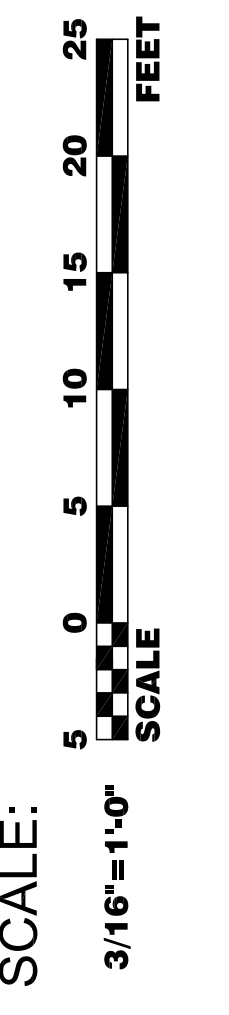

MC BEAMLINE ENCLOSURES
 BEAMLINE ENCLOSURES PLAN - SHEET 2

CDR



DATE

20 DEC., 2013

PROJECT NO.

6-10-22

DRAWING NO.

S-2